

# DIVINE™ 160

The Divine 160 is a high-performance 440W luminaire with phenomenal light output that can be used for a variety of architectural lighting scenarios including the application of dynamic colour changing effects to building exteriors and façades, or illuminating complete areas with subtle CCT controllable white light. The Divine is available in numerous configuration options including optics for flood or accent lighting, RGBW, RGBA or PureWhite in a variety of colour temperatures combined with different mounting options and accessories make Divine a truly flexible solution.



## KEY FEATURES

Multichip optical system delivers superb light with enhanced 18 bit control. Compact & lightweight.

### Lumen Output & Light Source

Up to 11,836 lm delivered (RGBW at 13° all LEDs on full)  
40 x High Power Multichip LEDs

### Projected Lumen Maintenance

Long LED life over 60,000 hrs (L70@25°C)

### Power Consumption

Typical power consumption 440W

## CONTROL & PROTOCOLS



## STANDARD & SPECIFICATION

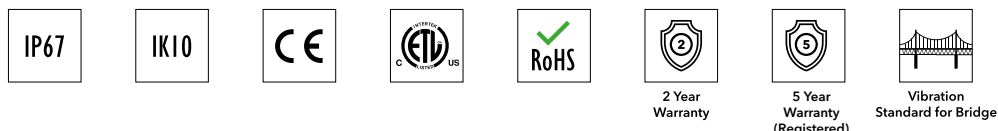

## COLOURS \* UPON REQUEST



## COLOUR TEMPERATURES \* UPON REQUEST

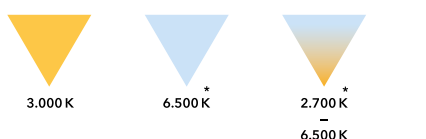

## FINISH OPTIONS

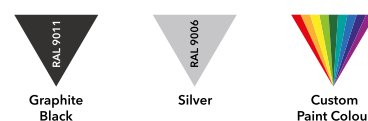

## OPTIC OPTIONS

### SYMMETRICAL



### BI-SYMMETRICAL

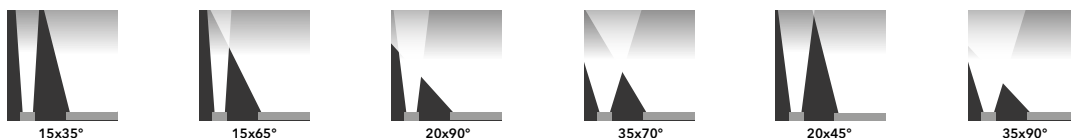

**DIVINE 160 SPECIFICATION**

<b>ELECTRICAL</b>	<b>Input Voltage</b>	100 - 277 V AC 50/60 Hz
	<b>Typical Power Consumption</b>	440 W +/- 10 %
	<b>Inrush Current</b>	30 A @ 230 V, 20 A @ 115V
<b>OPTICAL</b>	<b>Light Source</b>	40 x High Power Multichip LEDs
	<b>Colour Variants</b>	RGBW (W - 6500 K), RGBA, PW (W - 3000 K)
	<b>Beam Angle</b>	Symmetrical: 13°   25°   35°   45°   65°   100°
		Bi-symmetrical: 15° x 35°   35° x 15°   15° x 65°   65° x 15°   20° x 45°   45° x 20°   35° x 70°   70° x 35°   35° x 90°   90° x 35°   20° x 90°   90° x 20°
	<b>Lumen Output Delivered</b>	11.836 lm (RGBW 13°, all LEDs on full)
<b>Projected Lumen Maintenance</b>	60.000 hrs (L70 @ 77 °F / 25 °C)	
<b>CONTROL</b>	<b>Display</b>	LED Display (Inside Integrated Junction Box)
		Chassis Mounted LED Display (Optional)
	<b>Wireless DMX (Option)</b>	Lumen Radio CRMX Technology
	<b>Interface Protocol</b>	USITT DMX512, RDM, 0-10 V
	<b>Control System</b>	Third Party DMX Controllers
	<b>Operating Modes</b>	DMX, Stand-alone
	<b>DMX Modes</b>	4
	<b>DMX Channels</b>	10, 22, 5, 4
	<b>Programs / Functions / Features</b>	Editable Program: 1 (up to 40 steps)
	<b>Settings / Addressing</b>	Via LED Display with Control Buttons or RDM
<b>Power Supply</b>	Integrated	
<b>PHYSICAL</b>	<b>Width x Height x Depth</b>	463 x 314 x 175 / 237 mm (18.2 x 12.4 x 6.9 / 9.3 in.)
	<b>Weight</b>	14.5 kg / 32 lbs
	<b>Housing</b>	High Pressure Die-Cast Aluminium Body
		Tempered Glass
	<b>Finish Options</b>	Standard Colour - Graphite Black (RAL 9011), Silver (RAL 9006)
		Cost Option - Custom RAL
	<b>Cables / Connections</b>	Integrated Junction Box With Terminal Block
		Recommended: Li9Y11Y 3 x AWG16 + 1(2 x AWG24)
	<b>Mounting Method</b>	Surface Mount, Flush (J-Box), C-Clamp (For Side Connection Only)
	<b>Adjustability</b>	+35° / -90°
	<b>Protection Factor</b>	IP67 / Suitable For Wet Locations
	<b>IK Rating</b>	IK10
	<b>Cooling System</b>	Convection
<b>Operating Ambient Temperature</b>	-20 °C / +40 °C (-4 °F / +104 °F)	
<b>Operating Temperature</b>	+75 °C @ Ambient +40 °C (+167 °F @ Ambient +104 °F)	
<b>Total Heat Dissipation</b>	1500 BTU/h (calculated)	
<b>CERTIFICATION</b>	<b>Listings</b>	ETL / cETL, CE, RoHS
<b>ACCESSORIES</b>		Surface Mount Adaptor (Included)
		Optical Demo Set for Divine 160
		Top Hat Divine 160
		Half Top Hat Divine 160
		Barn Door Module Divine 160
		Wire Guard/Anti-Glare Divine 160
		Set of Rubber Feet
		C-Clamp Adaptor Divine (for side conn. only)
	Single Top Loader Case Divine	

PHOTOMETRIC OVERVIEW

	Lumen Output (lm)		
	RGBW	RGBA	PW (3000 K)
13°	11 836	7 697	9 673
25°	10 903	7 090	8 910
35°	10 882	7 076	8 893
45°	10 876	7 072	8 888
65°	10 842	7 050	8 860
100°	10 514	6 837	8 592
15° x 35°, 35° x 15°	10 628	6 911	8 685
15° x 65°, 65° x 15°	11 017	7 164	9 003
20° x 45°, 45° x 20°	10 981	7 141	8 974
35° x 70°, 70° x 35°	10 912	7 096	8 918
35° x 95°, 95° x 35°	10 495	6 825	8 577
20° x 90°, 90° x 20°	11 022	7 167	9 007

DIMENSIONS

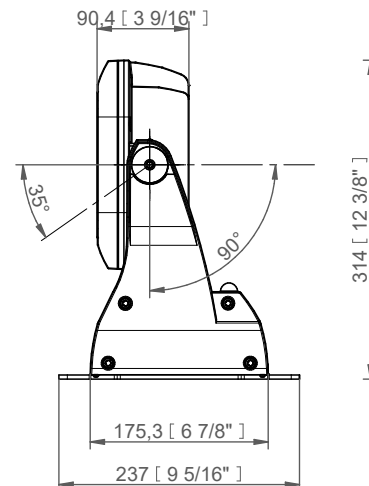
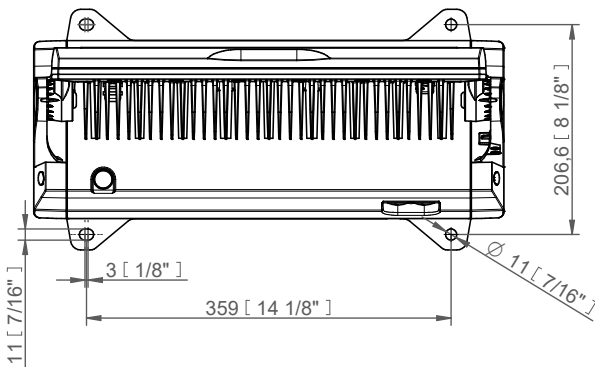
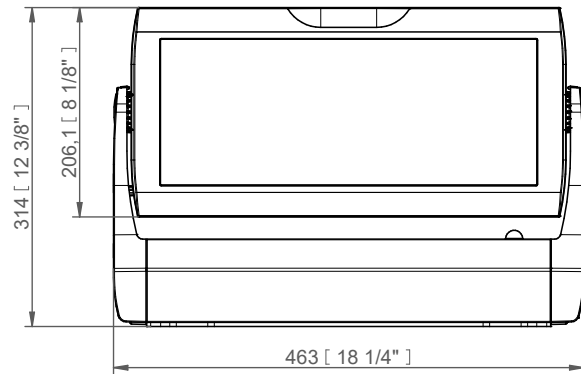
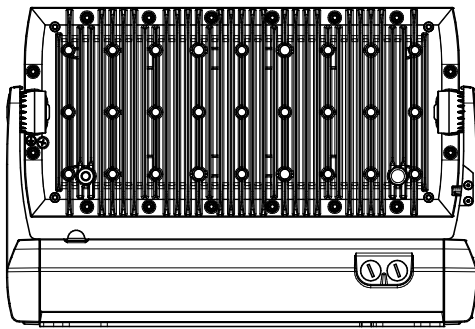

**ACCESSORIES FOR DIVINE 160**

Top Hat Divine 160

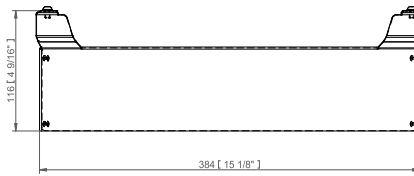
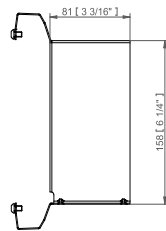
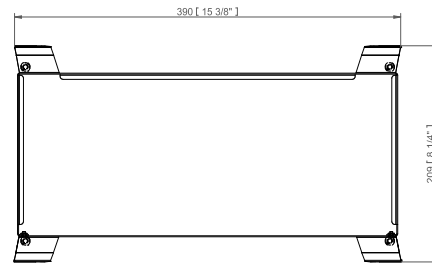

Half Top Hat Divine 160

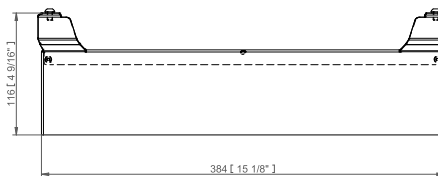
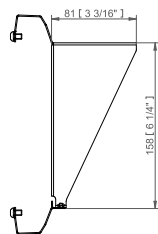
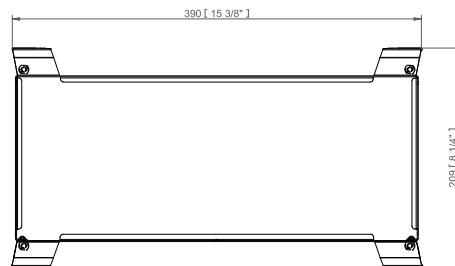

Barn Door Module Divine 160

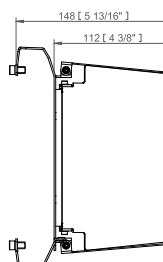
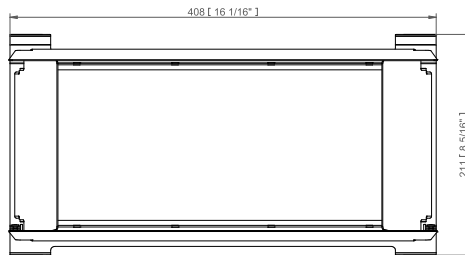

Wire Guard /Anti-Glare Divine 160

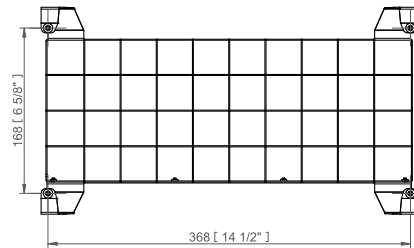
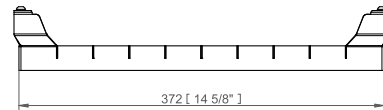
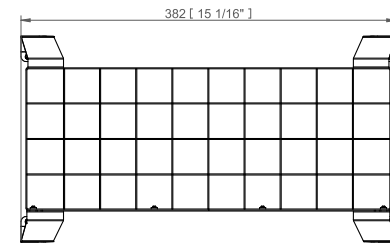
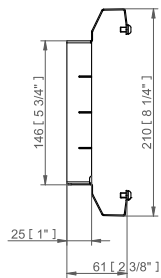
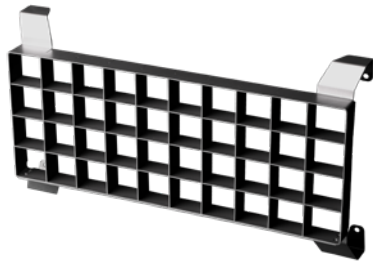

C-Clamp Adaptor Divine (for side conn. only)

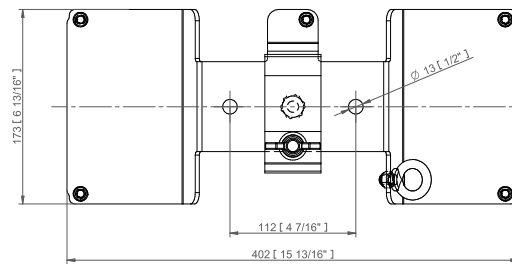
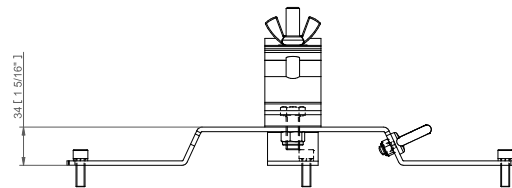
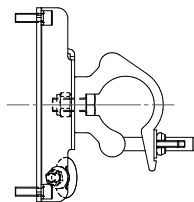
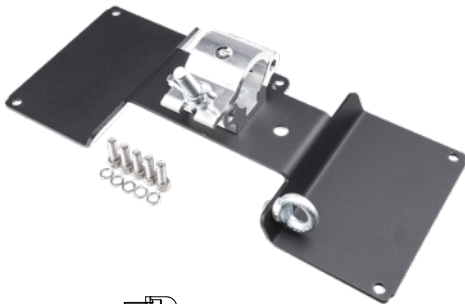

Set of Rubber Feet - Graphite / Silver

